

SureStrike™ 6.5X55 Adaptor USER GUIDE

* It is recommended that you read the complete user guide before using your SureStrike!



WARNING: Firearms can cause serious injuries or death.
Before any training session perform the following steps:

Safety first:

- Unload the weapon.
- Physically and visually inspect the chamber, bore, and magazine well to ensure that all ammunition has been removed.
- Unload ammunition from any magazines that will be used in training.
- Store ammunition in an area that is separate from your training area.



Always personally verify that all ammunition has been removed before training.
Do not allow any live ammunition in the training area.

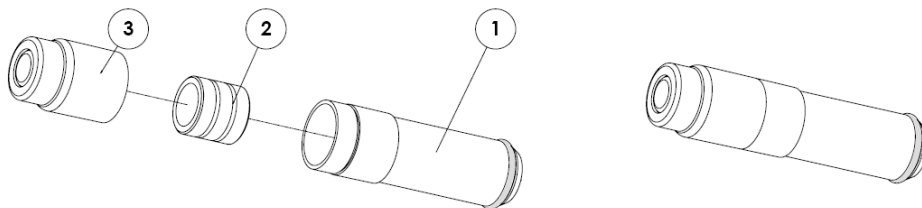

SureStrike Assembly:

1. Take your laser assembly (1) and insert the battery pack (2) according to the drawing (Plus side - flat side, facing up)
2. Take a '9mm' action cap (3) **or** a '223 for AR15' action cap and thread it onto the laser assembly (1) with the battery installed. Verify the threading is fully closed and that there is no gap.
3. Push on the back of the striker pad to test for operation.

Connecting the 6.5 X 55 adaptor:

1. Open the 6.5X55 adaptor as shown.



2. Insert the SureStrike cartridge into the bigger opening of the 6.5X55 adaptor sleeve.

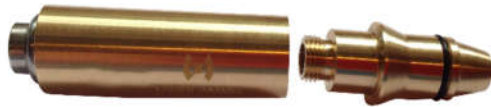

3. Thread tightly the front part of 6.5X55 adaptor into the front of the of the SureStrike cartridge.



4. It is recommended to lightly oil the O 2ring. Retract the bolt and engage the bolt stop in the open position. Make sure the bolt is held firmly by the stop.



Do not continue if the bolt is not held firmly or the bolt stop is not in good working order.

5. While pointing the barrel down, insert the 6.5X55 cartridge into the firearm by "dropping" it through the receiver (breech) opening into the chamber.
6. Push the 6.5X55 cartridge all the way into the chamber.
7. Still pointing down, move hands away from the receiver opening, close the bolt.
8. Point the weapon at a safe backstop and pull the trigger to verify that the unit is properly installed and functioning.

Disassembly:

1. Open the bolt and engage the bolt stop in the open position. Insert a cleaning rod, without the cleaning attachment or with a flat tip, into the barrel and gently push the 6.5X55 cartridge out.
2. Disassemble laser cartridge in the reverse order for assembly.

Remove battery when laser cartridge is not in use.